

Entry Restriction Signage

● What is entry restriction signage?

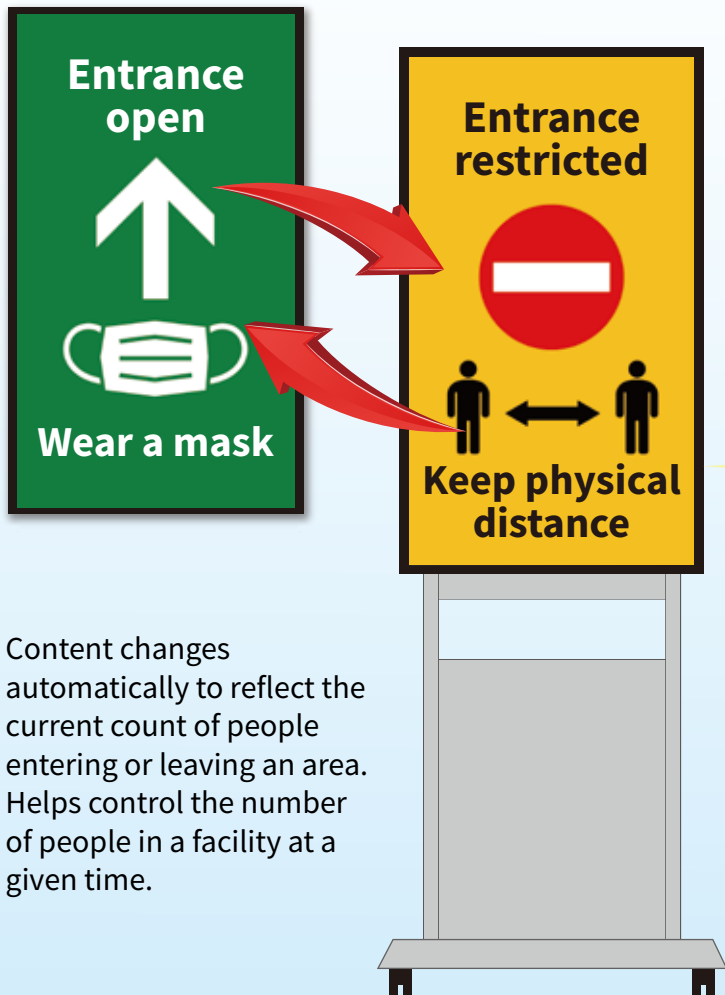

Content changes automatically to reflect the current count of people entering or leaving an area. Helps control the number of people in a facility at a given time.

A sensor installed on a display stand counts the number of people entering or leaving a facility. That information is then used to automatically switch preset content (A or B) depending on the number of people entering or leaving.

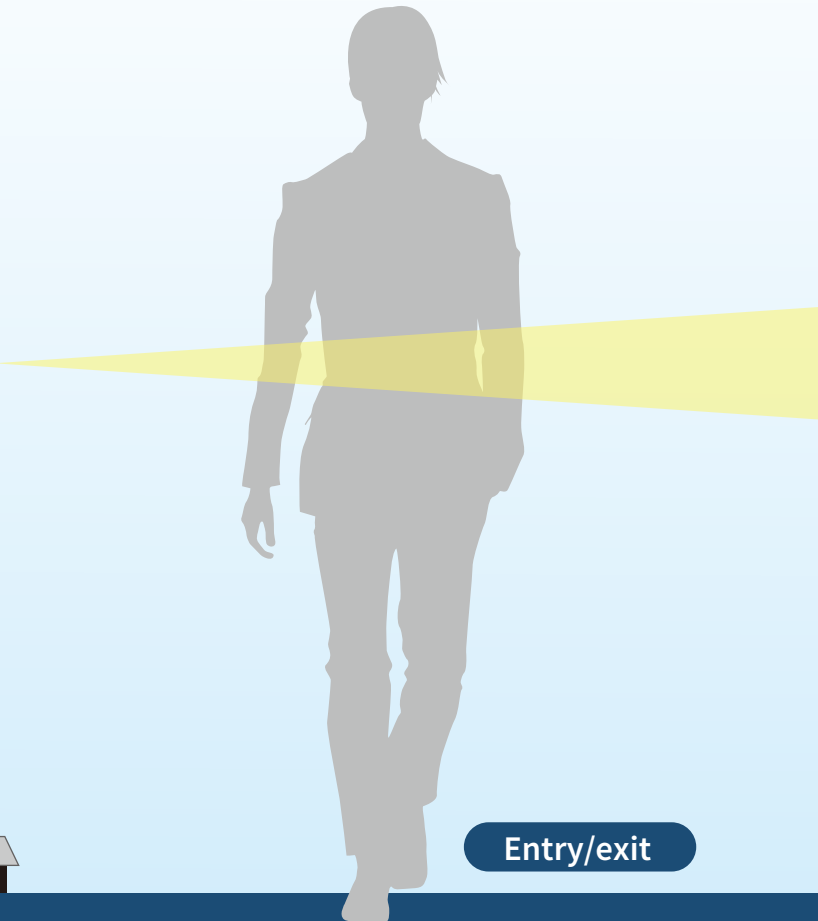

Entry restriction is an effective strategy for dealing with Covid-19. But it can also be used in various scenarios in which large numbers of people might jam into a space.

Basic Operation

- During normal times, regular content can be displayed.
- If the facility manager determines that a congested situation exists and restrictions are necessary, they can manually switch to the entry restriction display.
- After the restrictions have been removed, they can switch back to the normal display.

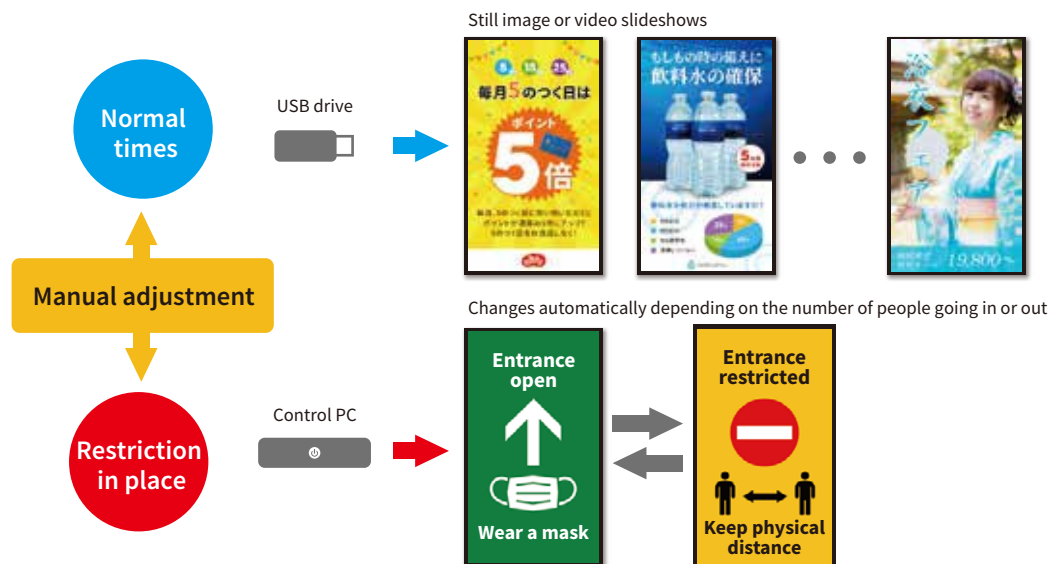

Display when restriction number is reached...

When the number of people inside the facility reaches the preset limit, the display automatically changes.
When the number inside drops below the limit, then the display returns to its previous setting.

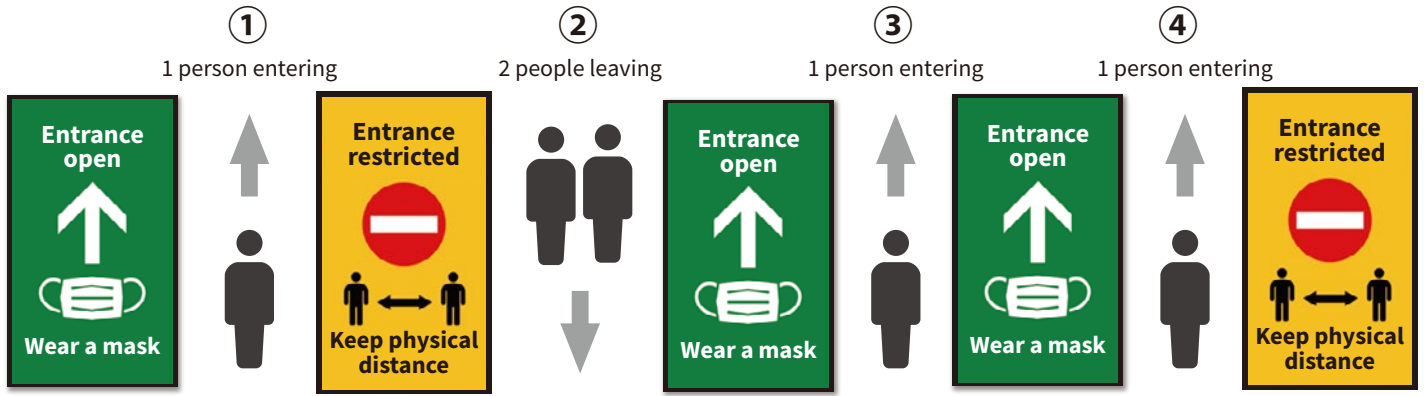

Installation Example

The detection area can be adjusted as needed according to the facility.

● Top view

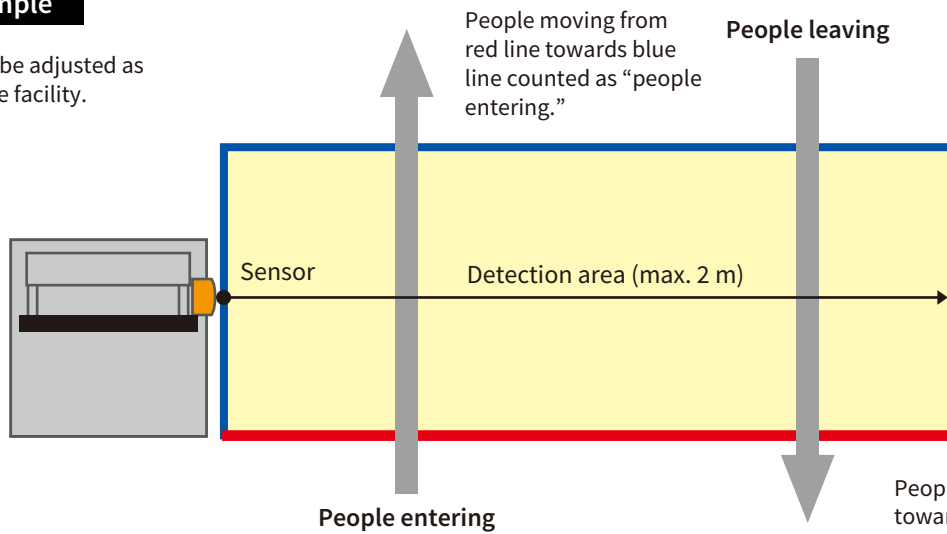

● Front view

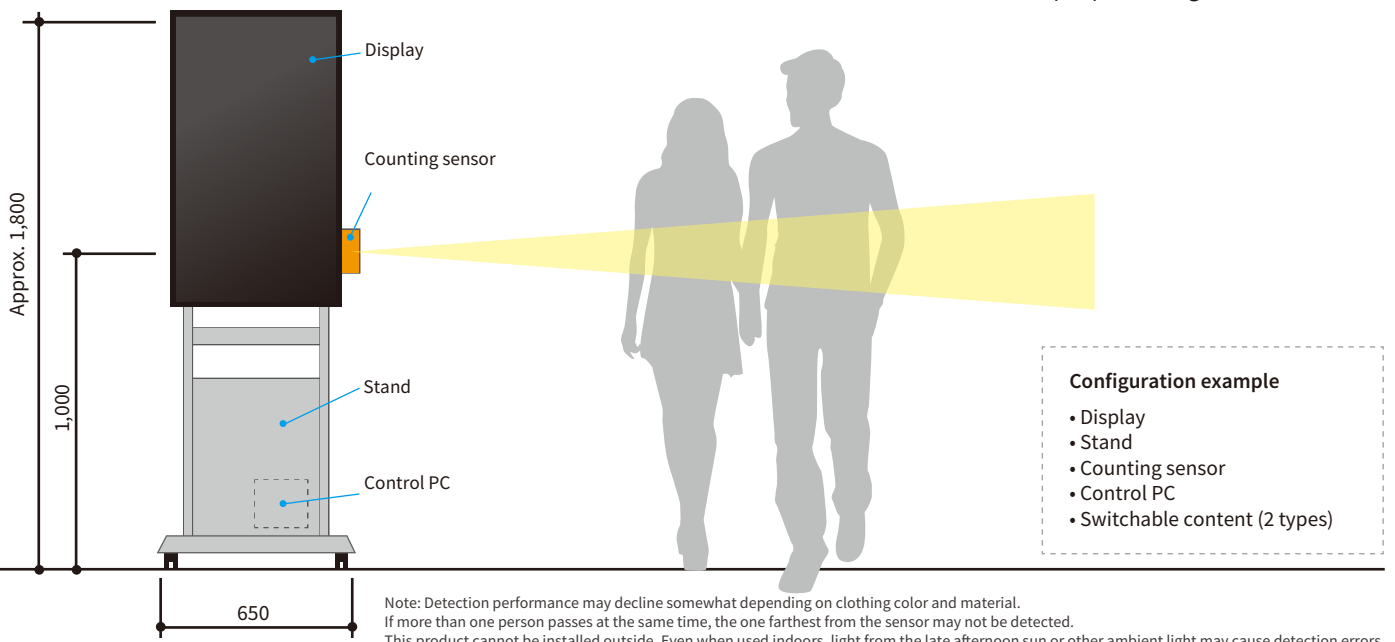

■ 発行者 (開発元)

アイプロダクツ[®]
-PRODUCTS by *Noritake-itrone*
 ノリタケ伊勢電子株式会社 〒519-2736 三重県会都郡打見670-5
<http://www.i-products.jp> TEL 0598-83-2364
 ☒ ipd@noritake-itrone.jp FAX 0598-83-2349

■ 問い合わせ (販売窓口)

シャープマーケティングジャパン株式会社
 ビジネスソリューション社
 ビジュアルソリューション営業推進部
 〒261-8520
 千葉県千葉市美浜区中瀬 1-9-2
 TEL 043-299-8409
 FAX 043-299-8415
<https://www.sharp-sbs.co.jp/>

■ 札幌	011-641-5101	■ 高松	087-823-4861
■ 仙台	022-288-8705	■ 広島	082-875-0220
■ 盛岡	019-637-8641	■ 福岡	092-575-6410
■ 名古屋	052-332-2651	■ 鹿児島	099-253-6128
■ 大阪	06-6794-9610		