

# SHARP

Be Original.

## BP-30C25

Digital Full Colour Multifunction System

Free to Fit  
Perfect for your business



# A versatile MFP to upgrade the way you work

Here is a smart and user-friendly MFP designed to fit in anywhere. Inside its clean and compact frame, it packs a huge range of essential functions to streamline your workflow. This versatile full-colour A3 MFP is built to match a diverse range of work styles. As a key player in your office team, it will drive your business forward into new realms of value.

Compact Size

All-in-one  
Functionality

Stylish Design



## Fits various business scenarios

Harnessing the versatility of digital data can help you streamline your operations and grab new business opportunities.

See more on pages 5-6

## Fits your everyday office needs

The LCD touchscreen with Easy UI mode gives everyone on your team easy access to everyday functions on the MFP.

See more on pages 3-4







## Fits your security demands

A secure environment supports admin staff in their duties and protects your business from risk.

See more on pages 9–10

## Fits a range of work styles

Because the MFP can connect to a variety of mobile devices and cloud services, you and your team can work anytime, anywhere.

See more on pages 7–8

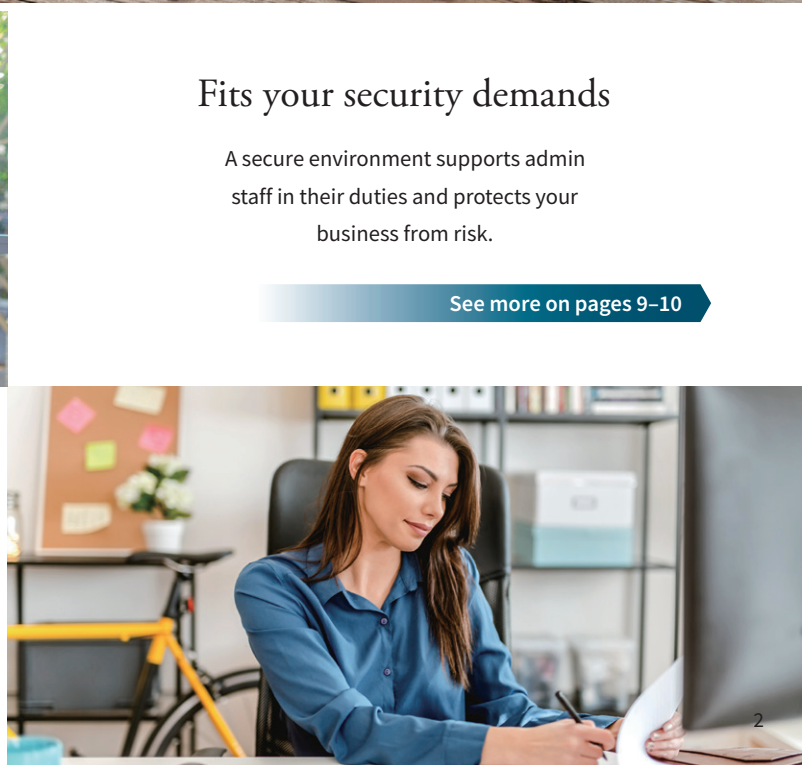



# Fits your everyday office needs

- ❑ Want an MFP that can be used intuitively
- ❑ Want neat, high-quality output
- ❑ Want an environmentally friendly workplace



## 7.0-inch LCD Touchscreen

The 7.0-inch colour LCD touchscreen makes it easy for anyone to use the MFP's advanced functions. The function icons incorporate a simple, straightforward design. Each user can customise the home screen by drag-and-dropping icons for commonly used functions.



## LED Status Lamps

On the control panel are two LED lamps: one red, one green. These light up to notify you—even from a distance—that, for example, the machine is “now printing” or “out of paper.”

## Pop-up Command Screen

Insert a USB drive into the MFP and a command screen will automatically pop up on the LCD. Right away you can print files from the USB drive—which are displayed as thumbnails\*—or you can scan documents directly to the USB drive.

\*Previews of Microsoft Office files require optional MX-PU10/PU10L.



## Easy UI Mode

In Easy UI mode, the touchscreen displays simple icons for frequently used functions like duplexing and paper size selection.

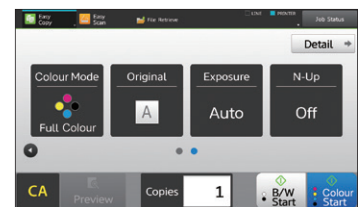

Enlarged icons allow easy access to the functions you need

## Quick Login

Just tap your dedicated user icon to access a personally customised operation screen. Customisable items include initial settings and onscreen language.



## Add a user—it's simple and easy

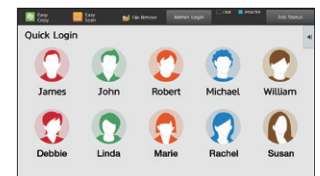
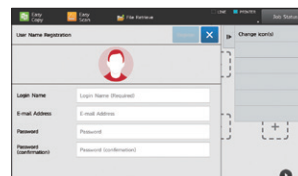

Choose an icon

Adding a user is easy via the touchscreen control panel. Simply choose an icon from the template.

## Free-tilting Control Panel

The control panel can be tilted freely at various angles. This gives you easy viewing and easy operation, no matter where the MFP is placed or who is using it.





## Easy Scanning

Tap on the LCD touchscreen's Auto Set button to have the MFP perform a host of actions automatically. It can determine scan resolution, skip blank pages in a multi-page document, or reorient pages mixed in upside down\*. Automatic functions like these save you time and effort, while ensuring optimal scan results.

\*Requires optional MX-EB20/EB20L.

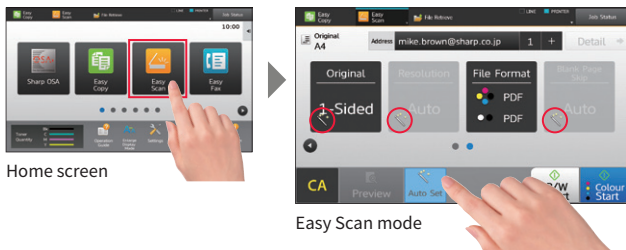

### ■ Automated settings that match the document

The MFP can tell whether a document being scanned is colour or B/W. If it is B/W it can automatically select the optimal setting for text—monochrome or greyscale.

### ■ Corrects skewed documents

The MFP detects skewed documents\* and automatically adjusts them, so you don't have to re-scan them.

\*PDF format only.

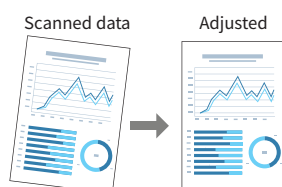

## Fast Wake Up from Sleep Mode

This MFP recovers quickly from energy-saving Sleep mode. Placing a document in the RSPF or touching the LCD control panel wakes the MFP up in just one second\*. This helps to minimise waiting time and get your jobs done faster.

\*When in Fast Wake Up mode.



## Energy Efficient

To reduce power consumption, Sharp has applied its advanced technologies across all areas of this MFP. Energy-saving functions include a short warm-up time and low power consumption of only 0.5 W\* in fax or network standby mode.

\*May vary depending on usage environments.

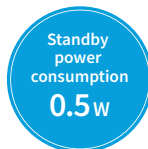

## Auto Power Shut-Off

To save electricity, an auto power shut-off function automatically puts the MFP into energy-saving mode after a period of inactivity. Shortly before this mode begins, a message appears on the LCD indicating that the MFP will soon shut down and giving you the option to continue operation.

## Easy, High-quality Scanning and Copying

Through an advanced three-step process, Auto Colour Mode provides faithful and fully automated copying and scanning in both colour and B/W—all with a simple press of the Start button. Here's how it works: Auto Colour Selection automatically determines whether a page is colour or B/W. Auto Original Type Selection then analyses page contents to distinguish between different components (such as photos, text, and text on halftone backgrounds) and selects the appropriate mode. It uses machine learning to optimally reproduce text and images. Finally, Background Suppression\* automatically removes unnecessary background colour.

\*May not work depending on the colour of the background or type of document.

### Auto Colour Mode

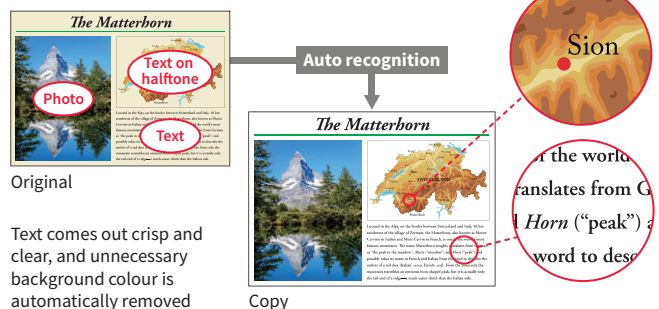

## Automatic Document Feeding

An RSPF (reversing single pass feeder) efficiently feeds in up to 100 sheets of either one- or two-sided originals. Because you can feed in a batch of multiple pages at once, it boosts copying and scanning efficiency.



## Automatic Toner Cartridge Eject Function

This function expels completely empty cartridges in preparation for replacement. The cartridge is replaced only after all the toner has been consumed, thereby ensuring efficient use of toner. Because you can tell at a glance when cartridges are empty, they are fast and easy to replace.

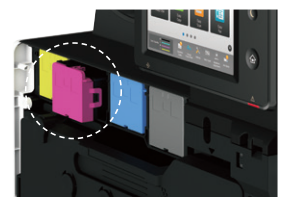

## Power ON/OFF Schedule

This function automatically turns the MFP on or off per administrator-set schedules.

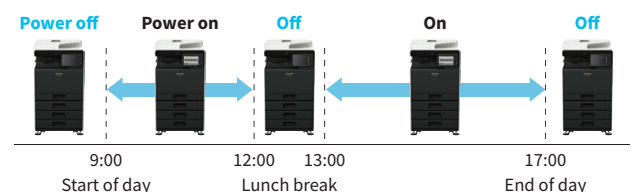

## Eco Recommendation

This function suggests environmentally friendly settings before a print\*/copy command is executed from the control panel.

\*For printing Document Filing data and direct printing (FTP/SMB/USB).



# Fits various business scenarios

- ❑ Want to reduce paper use
- ❑ Want to use digital data effectively
- ❑ Want to streamline business processes



## Card Shot Function

The MFP lets you easily copy both sides of a card onto a single page. Whether it's an ID card or a driver's license, you save time, effort, and paper.

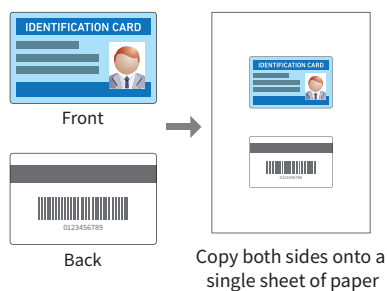

## Printing Two Pages on One Sheet

Duplex printing allows printing on both sides of a sheet of paper. The MFP can also print two pages of content on the same side of a sheet of paper. Using both of these functions at the same time lets you print four pages on one sheet. It's a great way to reduce paper use and cut paper costs.

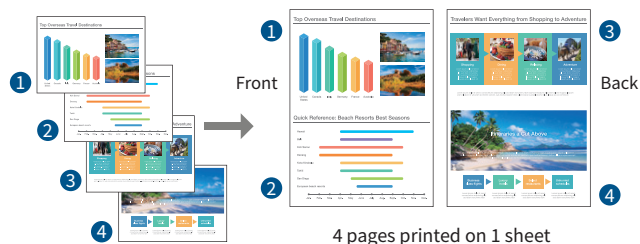

## Versatile Paper Handling

The main unit paper tray can take paper sizes from A3 to A5, while the multi bypass tray can also handle A6 paper. The optional paper feed units handle paper up to 220 g/m<sup>2</sup> thick, while the multi bypass tray takes paper up to 256 g/m<sup>2</sup> thick\*. In addition to plain paper, the MFP can handle a number of other paper types\*, such as envelopes, removable adhesive paper, and glossy paper.

\*1: 256 g/m<sup>2</sup> thick paper cannot be fed via main unit paper tray.

\*2: Must be fed via multi bypass tray.

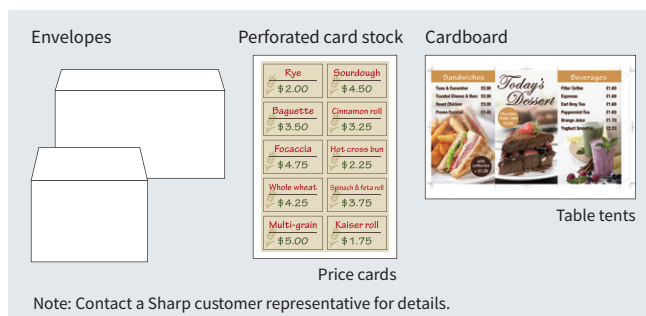

## Rotation Sort\*

Every other copy of a document is rotated 90 degrees when it's delivered to the output tray. This takes the hassle out of sorting copies and comes in handy when you need to print many copies of multi-page documents.

\*Two paper trays must be loaded with the same-sized paper in a different orientation (landscape and portrait).

Example: Making 2 copies of a 2-page document



## Custom Images

By storing image files of your choice—like your company's logo—on the MFP, you can easily add them to copies and printouts.



## Multicrop and Image Crop Functions

Multiple receipts, photos, and other items can be scanned all at once, with each one saved as a separate file. This helps you streamline the filing of receipts and bills. The MFP can also crop photos from documents such as magazine pages and save them as individual files.

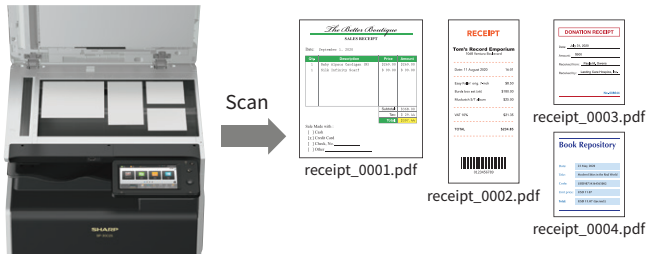

## Convert Documents via OCR\*

OCR capability on this MFP lets you convert a scanned document into a searchable PDF file or into an editable Office Open XML (docx, xlsx, pptx) file.

\*Requires optional MX-EB20/EB20L.

## Business Card Scanning\*

The MFP can scan multiple business cards at once. It reads the contact details on each card via OCR\* and then exports the details to your chosen contact management system.

\*Requires optional MX-EB20/EB20L.

## Versatile Fax Functions\*

The MFP gives you all the benefits of standard fax functionality. It also supports paperless faxing, so you can check faxes anytime, anywhere and respond accordingly. You'll be able to handle all sorts of fax-related work with ease.

\*Fax requires optional MX-FX15, and Internet fax requires optional MX-FWX1/FWX1L.

### Inbound routing

Inbound routing lets you forward incoming faxes to a pre-designated location, such as a PC desktop\*, FTP server, network folder, or email address without printing to paper. This allows you to check faxes even when you're out of the office, and it makes it easier to separate incoming faxes intended for different recipients.

\*Requires Network Scanner Tool Lite.

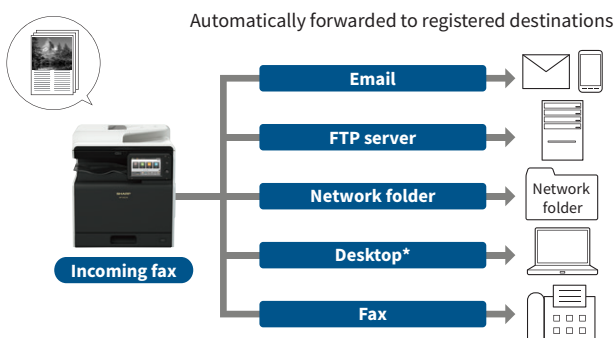

## Multiple Scan Destinations

There are many ways to distribute scanned documents. They can be sent to an FTP server, to a network folder, or to a USB drive. Or they can be sent directly to a designated PC desktop\*<sup>1</sup> or as email attachments. A compact PDF function\*<sup>2</sup> ensures that PDF files are sent and received smoothly.

\*1: Requires Network Scanner Tool Lite.

\*2: Requires optional MX-EB19/EB19L.

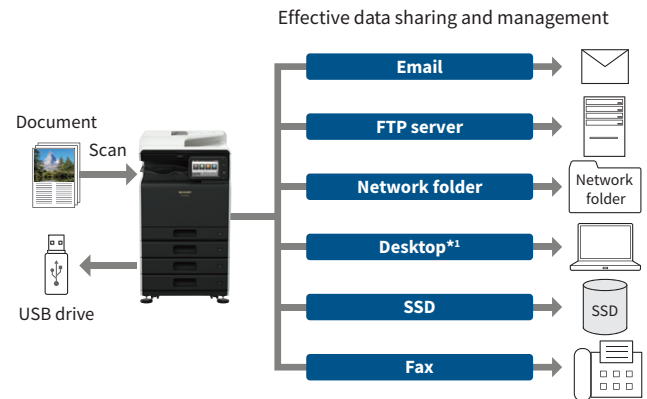

## Network Scanner Tool Lite\*

This lets you send documents scanned on the MFP to your PC or mobile device and save them in a specified folder there. It can even work if you're out at a client's office. Network Scanner Tool Lite can detect the nearest MFP and let you upload scans to your laptop or mobile device. There's no need to make special settings.

\*Download from the following website: <https://global.sharp/products/copier/downloads/>

### Incoming fax auto save and preview

The MFP automatically saves incoming fax data. It allows you to preview faxes on the LCD control panel before printing them out. This gives you the option of printing them out if needed, deleting them, or forwarding them to a PC or mobile device. You can also keep them on the MFP's storage device to use at a later time. Because the MFP can save incoming faxes without immediately printing them, it can reduce your paper and toner usage.

### Internet fax

This MFP lets you exchange faxes via email with other compliant fax machines. Compared to conventional phone line faxing, Internet faxing saves on telecommunication costs.

### PC-fax transmission

You can directly send a document created on your PC to a recipient's fax machine via the MFP. This saves time, effort, and paper, because you don't need to print the document before faxing it.



# Fits a range of work styles

- ❑ Want to keep up with diversifying work styles
- ❑ Want to print or scan from devices other than PCs
- ❑ Want to access the company system from outside the office



## Link with Mobile Devices\*

Connecting the MFP to one or more mobile devices is easy, and it expands your options for sharing data. Not only can you send scanned documents to mobile devices such as smartphones and tablets, you can also print documents or photos sent from those devices.

\*Requires wireless LAN connection or optional MX-EB18. Availability of this option varies by country/region.



### ■ Sharpdesk Mobile\*<sup>1</sup>

This print/scan app lets you easily link your mobile device to the MFP by simply holding it over the MFP's NFC card reader\*<sup>2</sup> or by scanning the MFP's QR Code.

\*1: Availability varies by country/region. For details, see the Sharpdesk Mobile support website:

[https://global.sharp/products/copier/docu\\_solutions/mobile/sharpdesk\\_mobile/](https://global.sharp/products/copier/docu_solutions/mobile/sharpdesk_mobile/)

\*2: The NFC interface is for Android™ devices running Android 9 or earlier. Requires third-party NFC card reader. Contact a Sharp customer representative for details.

### ■ Sharp Print Service Plugin\*

This mobile printing technology allows printing from Android devices.

\*Available at a later date. Availability varies by country/region. For details, see the Sharp Print Service Plugin support website:

[https://global.sharp/products/copier/docu\\_solutions/mobile/Sharp\\_Print\\_Service\\_Plugin/index.html](https://global.sharp/products/copier/docu_solutions/mobile/Sharp_Print_Service_Plugin/index.html)  
Requires optional MX-PK13/PK13L.

### ■ AirPrint\*

The MFP supports the AirPrint printing feature in Apple devices. It lets you print directly from a mobile device without the need for a print driver.

\*Requires optional MX-PK13/PK13L.

## Wireless Connections\*

The MFP offers ultra-handly wireless access, enabling convenient access to the MFP even from places where it's difficult to connect a LAN cable.

\*Requires optional MX-EB18. Availability of this option varies by country/region.

## Link with Mail Servers

Scanned data can be conveniently sent via your regular Gmail™ or Microsoft Exchange/Online\* account.

\*Exchange Server 2010/2013/2016/2019, Exchange Online

## Office Direct Printing\*

Print common Microsoft Office files without using a PC. With this MFP, you can print a Word, Excel, or PowerPoint file directly from a mobile device, cloud service, USB drive, or file server.

\*Requires optional MX-PU10/PU10L. The actual printout may look different from what is displayed on the computer screen. This function is enabled via Qualcomm® DirectOffice™ technology.



## Link to Cloud Services\*<sup>1</sup>

The MFP connects with cloud services directly from its control panel, letting you upload scanned data to or print directly from any of them\*<sup>2</sup>. Once you log in to the MFP, its single sign-on feature allows you to quickly access multiple software services without having to sign in to each one separately. You can also download and install apps on your MFP via Sharp's Application Portal. App updates are easily recognisable, so you'll always be up-to-date on the latest services.

\*1: Requires optional MX-AMX2/AMX2L. Contact a Sharp customer representative for details.

\*2: Direct printing of PDF files requires optional MX-PK13/PK13L; direct printing of Microsoft Office (pptx, xlsx, docx) files requires optional MX-PU10/PU10L.

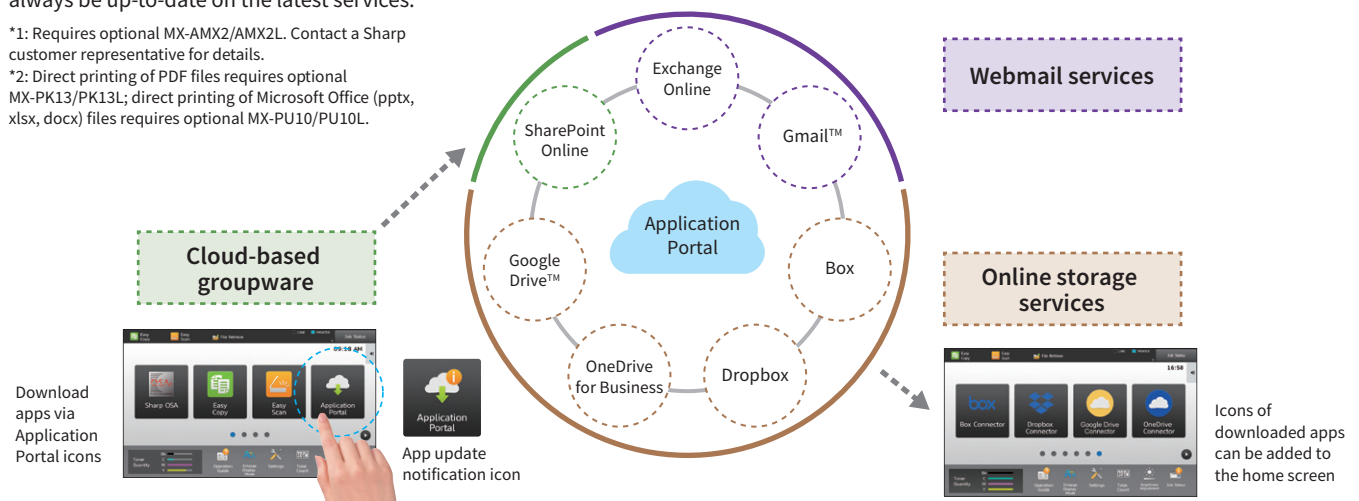

## Print Release\*

The Print Release function lets you send documents to the main MFP. This MFP acts as a server and stores them for printing out from any other compatible MFP on the network. The document won't be output until you log in to the MFP, select the document, and execute a print command. This prevents you from printing the wrong document, forgetting documents in the output tray, or having others see your confidential documents. Print Release is easy to set up for admin staff and doesn't need a separate server.

\*Contact a Sharp customer representative for details on the recommended maximum number of connectable MFPs.

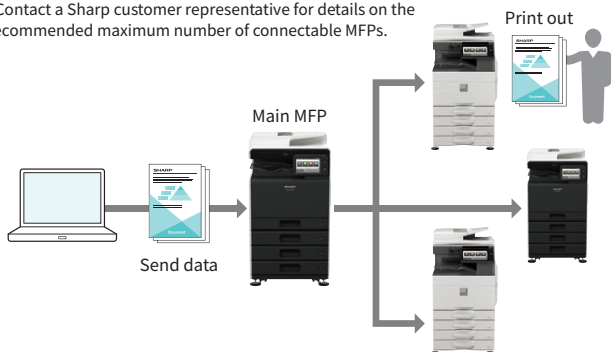

## Document Filing

Document Filing allows files that have been copied, printed, scanned, or faxed\* to be stored by job on the MFP's solid-state drive. From there, they can be instantly recalled for printing and sending at a later time. You can also combine multiple stored files into one, enabling easy and effective use of data.

\*Fax requires optional MX-FX15, and Internet fax requires optional MX-FWX1/FWX1L. For fax and Internet fax jobs, only transmitted data (not received faxes) can be saved via the Document Filing function.

### ■ Quick File folder

Storing data in a Quick File folder lets you instantly reuse the file you need.

### ■ Main and Custom folders

Main folders can be assigned user names and shared across your workgroup. Custom folders require users to enter a password for access, so your sensitive data can be protected.

## Secondary Ethernet Port\*

A secondary Ethernet port allows the MFP to support two separate networks. You can set up different IP addresses and security settings for each line—one in-house, say, and one for visitors. Alternatively, the MFP could be set up to access a web-connected office network as well as a high-security offline network.

\*Requires an Ethernet adaptor that supports two lines. Contact a Sharp customer representative for details.

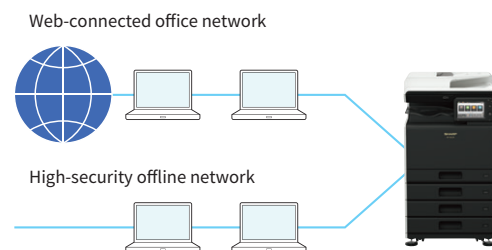

## Sharp OSA\* (Open Systems Architecture)

Sharp OSA technology allows you to interact with intra-company systems and network applications right from the LCD control panel. And since Sharp OSA utilises industry-standard network protocols, the MFP can easily integrate with third-party document management systems, enterprise resource planning software, workflow applications, and more.

\*Requires optional MX-AMX2/AMX2L and/or MX-AMX3/AMX3L.



## Remote Operation\*

The Remote Operation function lets you display the MFP's main control panel on the screen of your PC or mobile device. From a remote location, you can then check MFP settings or reprint data stored on the MFP.

\*Requires VNC application. Simultaneous remote operation from two or more PCs or mobile devices is not possible. Remote operation also depends on the network environment and applications being used. Contact a Sharp customer representative for details.



# Fits your security demands

- ❑ Want to protect confidential information
- ❑ Want first-rate data safeguards
- ❑ Want user peace of mind

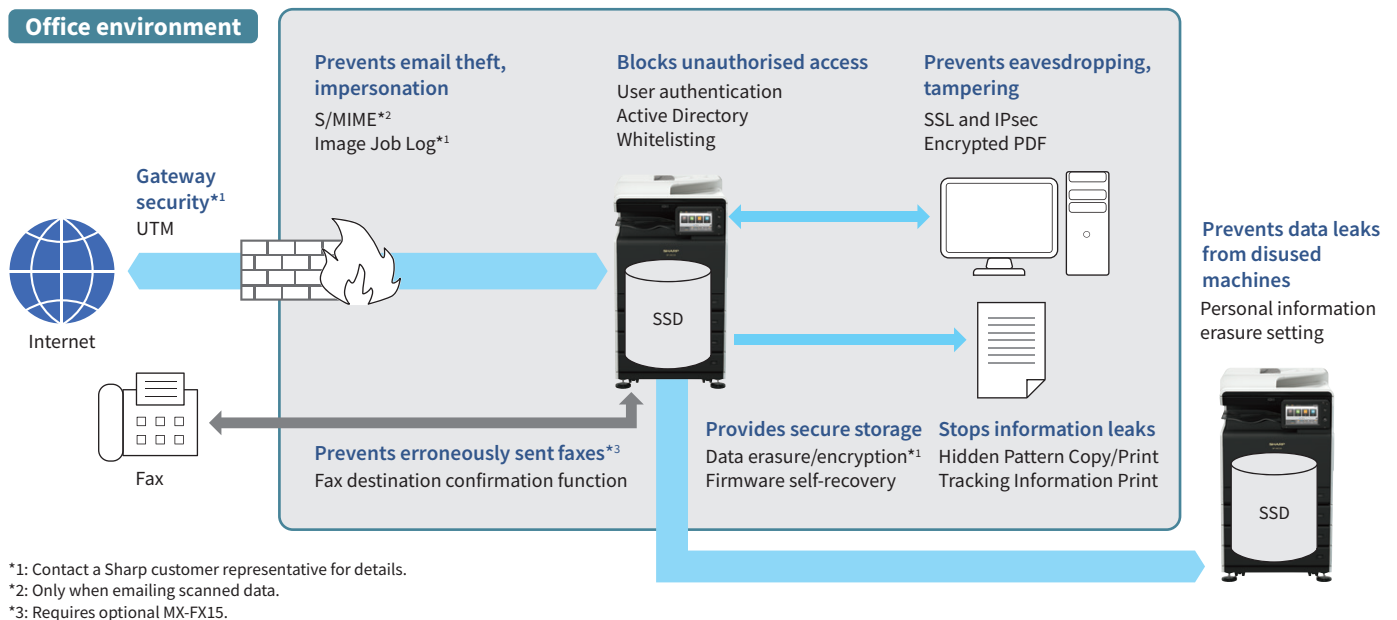

## Document Control

This function prevents unauthorised use of confidential documents\* by embedding copy prevention data in them.

\*Requires optional BP-FR10U. May not work with certain types of paper, documents (such as those with a lot of photos), or MFP settings.

## Hidden Pattern Copy/Print Function

Documents can be embedded with a watermark when they are output. The next time the documents are copied, a pattern or message appears in the background on the copy, thus effectively deterring unauthorised copying of confidential or personal information.

## Tracking Information Print

This function prints the MFP user's name, the date, job ID, and other specifics on printouts, making it possible to track documents.

## Data Encryption and Automatic Erasure\*

Job data is encrypted before being saved to the MFP's internal storage. Once the data is output or sent, it is automatically erased.

\*Contact a Sharp customer representative for details on activating this function.

## Firmware Self-recovery

Prevents firmware damage by quickly and automatically restoring files when abnormal firmware activity is detected.

## Personal Information Erasure

Initialising the MFP allows you to delete personal information and other data stored on it. This security function helps prevent leakage of personal information and important documents after the machine is disposed of.

## Active Directory

By linking the MFP with Active Directory, users can access cloud services and network folders via the MFP by logging in with their authentication information. Beside the convenience of this single sign-on for users, system administrators can maintain a high level of security.

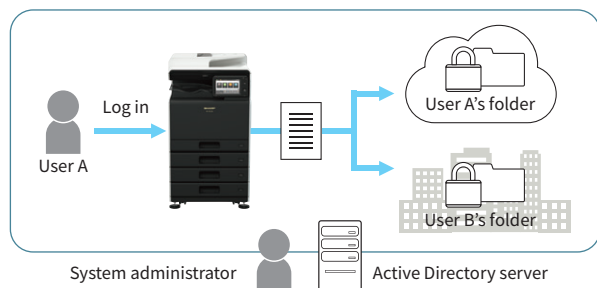

## Server Authentication

The MFP supports external server authentication functions such as LDAP and Active Directory. With centralised management of multiple user credentials, system administrators can keep track of multiple MFP usage.

## S/MIME\*

Supports email encryption and digital signature. Sending emails in encrypted format keeps data from leaking. It also prevents someone from masquerading as the sender or altering the content of an email.

\*Only when emailing scanned data.

## Image Job Log\*

This function creates and externally stores an image file (PDF) and a log file (XML) for each job. This helps identify unauthorised use of the MFP.

\*Contact a Sharp customer representative for details on activating this function.

## Whitelisting

Whitelisting protects the MFP from fraudulent programs trying to access the file system and obtain information.

## SSL and IPsec

SSL (secure sockets layer) and IPsec data encryption technologies ensure secure network communications.

## System Configuration

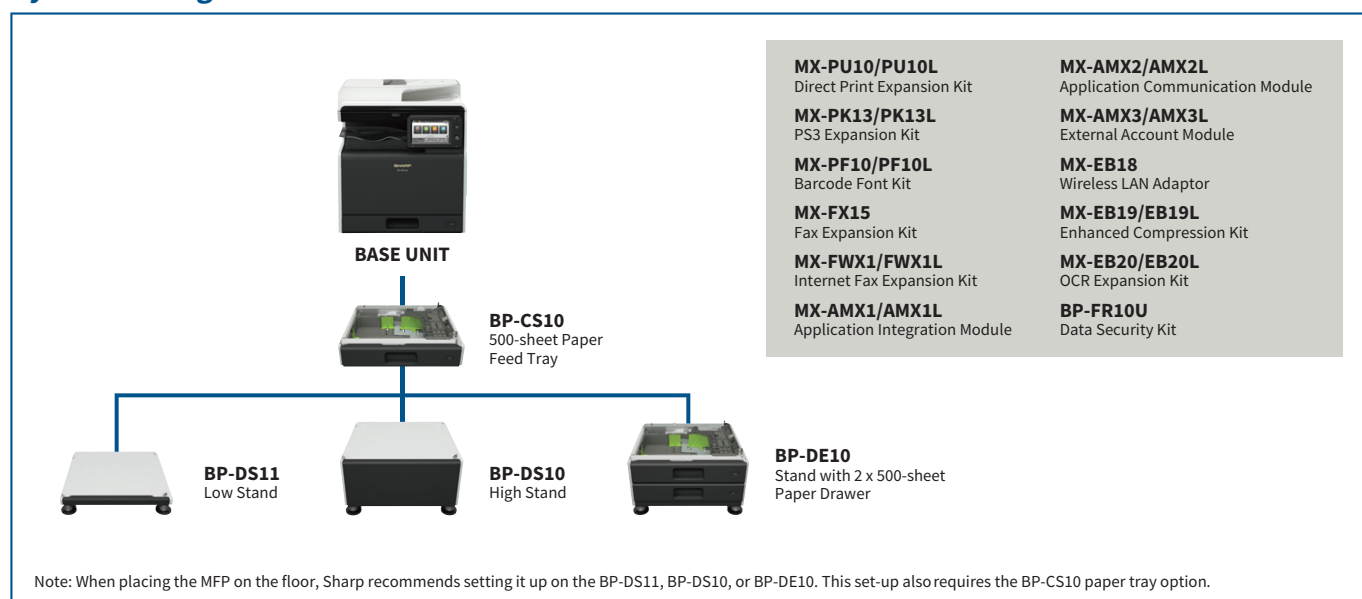

## Specifications for Optional Equipment

### BP-CS10 500-sheet Paper Feed Tray

Paper size	A3 (11" x 17") to A5 (5 1/2" x 8 1/2")*1
Paper capacity	500 sheets
Dimensions (W x D x H)	560 x 560 x 145 mm (22 1/16" x 22 1/16" x 5 23/32")
Weight (approx.)	6.7 kg (14.8 lbs)

### BP-DE10 Stand with 2 x 500-sheet Paper Drawer

Paper size	Upper and lower tray	A3 (11" x 17") to A5 (5 1/2" x 8 1/2")*1
Paper capacity	Upper and lower tray	500 sheets each
Dimensions (W x D x H)		560 x 585 x 329 mm (22 1/16" x 23 3/64" x 12 41/64")
Weight (approx.)		21 kg (46.3 lbs)

### BP-DS11 Low Stand

Dimensions (W x D x H)*2	560 x 585 x 102 mm (22 1/16" x 23 3/64" x 4 1/32")
Weight (approx.)	4.6 kg (10.2 lbs)

### BP-DS10 High Stand

Dimensions (W x D x H)*2	560 x 585 x 311 mm (22 1/16" x 23 3/64" x 12 1/4")
Weight (approx.)	11 kg (24.3 lbs)

Note: All specifications relating to paper capacity refer to 80 g/m<sup>2</sup> paper.

\*1: Only short-edge feeding can be used with A5 (5 1/2" x 8 1/2") paper.

\*2: Including adjusters and protuberances.



## SPECIFICATIONS

General		Document Filing	
Type	Desktop	Document filing capacity <sup>*13</sup>	Main and custom folders: 5,000 pages or 500 files Quick file folder: 5,000 pages or 500 files
Engine speed	A4 (8 1/2" x 11") <sup>*1</sup> : Max. 25 ppm A3 (11" x 17") <sup>*</sup> : Max. 14 ppm	Stored jobs <sup>*14</sup>	Copy, print, scan, fax
Control panel display	7.0-inch colour LCD touchscreen	Storage folders	Quick file folder, main folder, custom folder (max. 1,000 folders)
Paper size	Max. A3W (12" x 18"), min. A6 (5 1/2" x 8 1/2") <sup>*2</sup>		
Paper capacity (80 g/m <sup>2</sup> )	Standard: 350 sheets (250-sheet tray and 100-sheet multi bypass tray) Maximum: 1,850 sheets (350 sheets & optional 3 x 500-sheet tray)		
Paper weight	Tray 1: 60 g/m <sup>2</sup> to 105 g/m <sup>2</sup> (16 lbs bond to 28 lbs bond) Trays 2-4 (BP-CS10/DE10): 60 g/m <sup>2</sup> to 220 g/m <sup>2</sup> (16 lbs bond to 80 lbs cover) Multi bypass tray: 55 g/m <sup>2</sup> to 256 g/m <sup>2</sup> (13 lbs bond to 140 lbs index)		
Warm-up time <sup>*3</sup>	17 sec. <sup>*4</sup>		
Memory	5 GB (copy/print shared) 128 GB SSD <sup>*5</sup>		
Power requirements	Rated local AC voltage ±10%, 50/60 Hz		
Power consumption	Max. 1.84 kW (220 V to 240 V)		
Dimensions (W x D x H)	568 x 630 x 653 mm (22 3/8" x 24 13/16" x 25 23/32")		
Weight (approx.)	54 kg (119.1 lbs)		
Copier		Printer	
Original paper size	Max. A3 (11" x 17")	Resolution	600 x 600 dpi, 9,600 (equivalent) x 600 dpi
First copy time <sup>*6</sup>	Colour: 11.0 sec. B/W: 8.0 sec.	Interface	USB 2.0 (host, high-speed), 10Base-T/100Base-TX/1000Base-T, wireless LAN (IEEE 802.11 b/g/n) <sup>*15</sup>
Continuous copy	Max. 9,999 copies	Supported OS <sup>*16</sup>	Windows Server 2012, Windows Server 2012 R2, Windows Server 2016, Windows Server 2019, Windows Server 2022, Windows 8.1, Windows 10, Windows 11 Mac OS 10.9, 10.10, 10.11, 10.12, 10.13, 10.14, 10.15, 11, 12, 13, 14 TCP/IP
Resolution	Scan (colour): 600 x 600 dpi Scan (B/W): 600 x 600 dpi, 600 x 400 dpi Print: 600 x 600 dpi, 9,600 (equivalent) x 600 dpi (depending on copy mode)	Network protocols	LPR, Raw TCP (port 9100), POP3 (email printing), HTTP, FTP for downloading print files, IPP, SMB, WSD
Gradation	Equivalent to 256 levels	Printing protocols	Standard: PCL 6 emulation Option: Adobe PostScript 3
Zoom range	25% to 400% (25% to 200% using RSPF) in 1% increments	PDL	80 fonts for PCL, 139 fonts for Adobe PostScript 3
Preset copy ratios	Metric: 10 ratios (5R/5E), inch: 8 ratios (4R/4E)	Available fonts	
Scanner		Facsimile (requires optional MX-FX15)	
Scan method	Push scan (via control panel) Pull scan (TWAIN-compliant application)	Compression method	MH/MR/MMR/JBIG
Scan speed <sup>*7</sup>	Colour & B/W: Max. 52 originals/min.	Communication protocol	Super G3/G3
Resolution	Push scan: 100, 150, 200, 300, 400, 600 dpi Pull scan: 75, 100, 150, 200, 300, 400, 600 dpi 50 dpi to 9,600 dpi via user setting <sup>*8</sup>	Transmission time	Less than 3 seconds <sup>*17</sup>
File formats	TIFF, PDF, PDF/A-1a <sup>*9</sup> , PDF/A-1b, encrypted PDF, XPS, compact PDF <sup>*10*11</sup> , JPEG <sup>*11</sup> , searchable PDF <sup>*9</sup> , OOXML (pptx, xlsx, docx) <sup>*9</sup> , text (TXT [UTF-8]) <sup>*9</sup> , rich text (RTF) <sup>*9</sup>	Modem speed	33,600 bps to 2,400 bps with automatic fallback
Scan destinations	Scan to email/desktop <sup>*12</sup> /FTP server/network folder (SMB)/USB drive/local drive	Transmission resolution	From Standard (203.2 x 97.8 dpi) to Ultra Fine (406.4 x 391 dpi)
		Recording size	A3 to A5 (11" x 17" to 5 1/2" x 8 1/2")
		Memory	1 GB (built-in)
		Greyscale levels	Equivalent to 256 levels

<sup>\*1</sup>: Long-edge feeding.  
<sup>\*2</sup>: Only short-edge feeding can be used with 5 1/2" x 8 1/2" paper.  
<sup>\*3</sup>: In a standard measurement environment. May vary depending on operating conditions and environment.  
<sup>\*4</sup>: When starting the MFP via the power button. 28 seconds when starting via the main power switch.  
<sup>\*5</sup>: SSD capacity depends on procurement and sourcing status.  
<sup>\*6</sup>: Long-edge feeding of A4 (8 1/2" x 11") sheets from 1st paper tray, using document glass, MFP in fully ready condition. May vary depending on operating conditions and environment.  
<sup>\*7</sup>: Based on Sharp's A4 standard chart, using document feeder, long-edge feeding, one-sided scanning, and factory default settings. Scan speed will vary depending on the type of document and the scan settings.  
<sup>\*8</sup>: Resolution will vary depending on the size of the scanned area.  
<sup>\*9</sup>: Requires optional MX-EB20/EB20L.  
<sup>\*10</sup>: Requires optional MX-EB19/EB19L.  
<sup>\*11</sup>: Colour/greyscale only.  
<sup>\*12</sup>: Requires Network Scanner Tool Lite.  
<sup>\*13</sup>: Storage capacity will vary depending on the type of document and the scan settings.  
<sup>\*14</sup>: Some features require optional equipment.  
<sup>\*15</sup>: Requires optional MX-EB18. Availability of this option varies by country/region.  
<sup>\*16</sup>: Mac OS requires optional MX-PK13/PK13L.  
<sup>\*17</sup>: Based on Sharp's standard chart with approx. 700 characters (A4 or 8 1/2" x 11" long-edge feeding) at standard resolution in Super G3 mode, 33,600 bps, JBIG compression.

Qualcomm® DirectOffice™

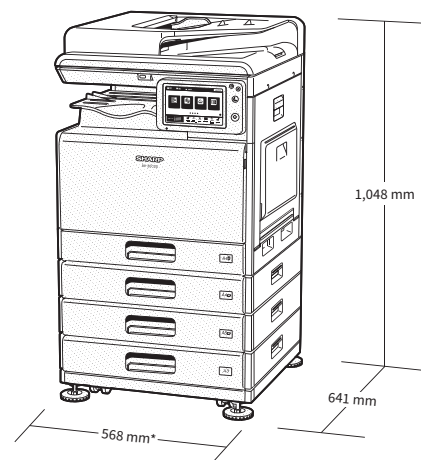

\* 883 mm when multi bypass tray is extended.

Shown with optional equipment.

Distributed by:

SHARP